

# Sample Graphic Solutions

1.5) Identify the drawing equipment shown in the diagram.

- A \_\_\_\_\_
- B \_\_\_\_\_
- C \_\_\_\_\_
- D \_\_\_\_\_

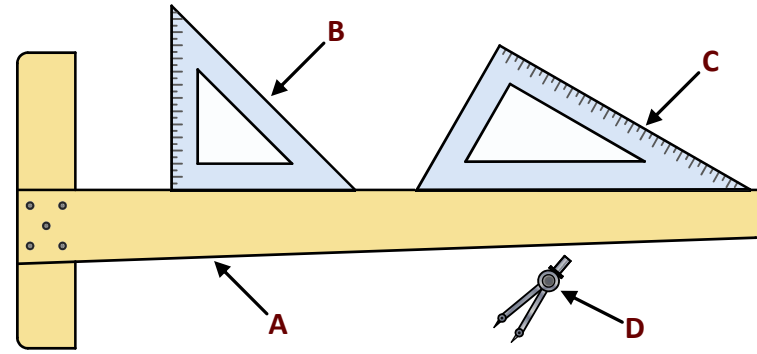

What is the difference between Horizontal and Vertical Lines?

1.6) The graphics shows a popular text term **LOL**.

- a. Answer the questions below.
- b. Draw the square grid in light construction lines, then recreate the graphic.
- c. Colour or shade the completed drawing.

Explain what is meant by Construction Lines:

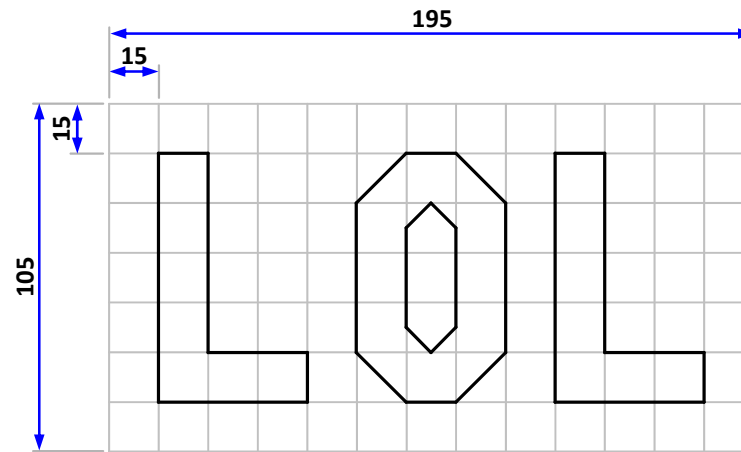

1.7) The graphics shows a character from Minecraft.

- a. Answer the questions below.
- b. Draw the square grid in light construction lines then recreate the character.
- c. Colour or shade the completed drawing.

Explain what is meant by Parallel Lines:

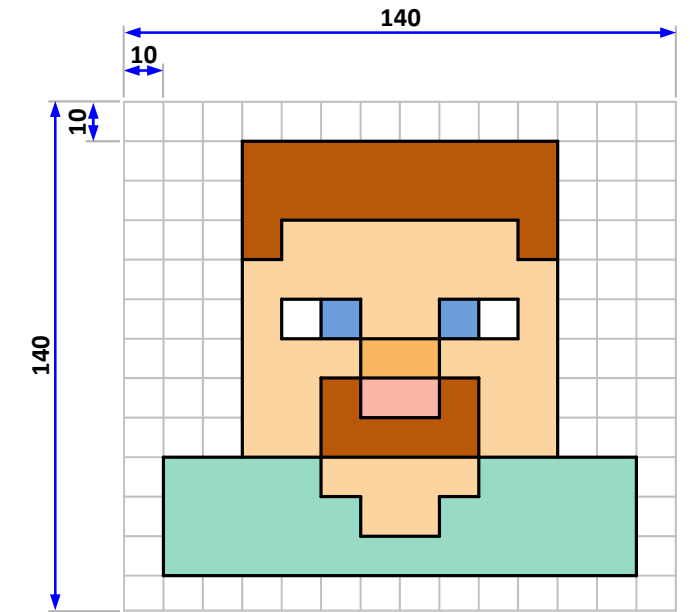

## Graphic Solutions

Name		Introduction to Graphics Sheet 3 Drawing with Equipment
Date		

# Sample Graphic Solutions

1.8) Calculate and write down the measurement of **A - F**.

**A** = \_\_\_\_\_      **B** = \_\_\_\_\_      **C** = \_\_\_\_\_  
**D** = \_\_\_\_\_      **E** = \_\_\_\_\_      **F** = \_\_\_\_\_

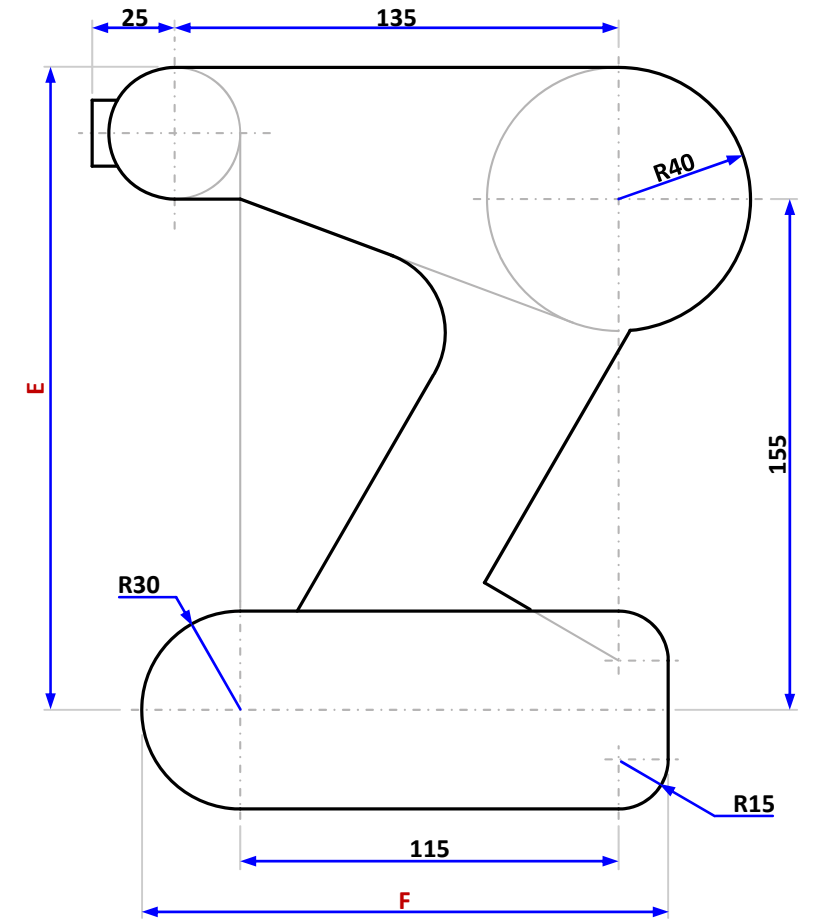
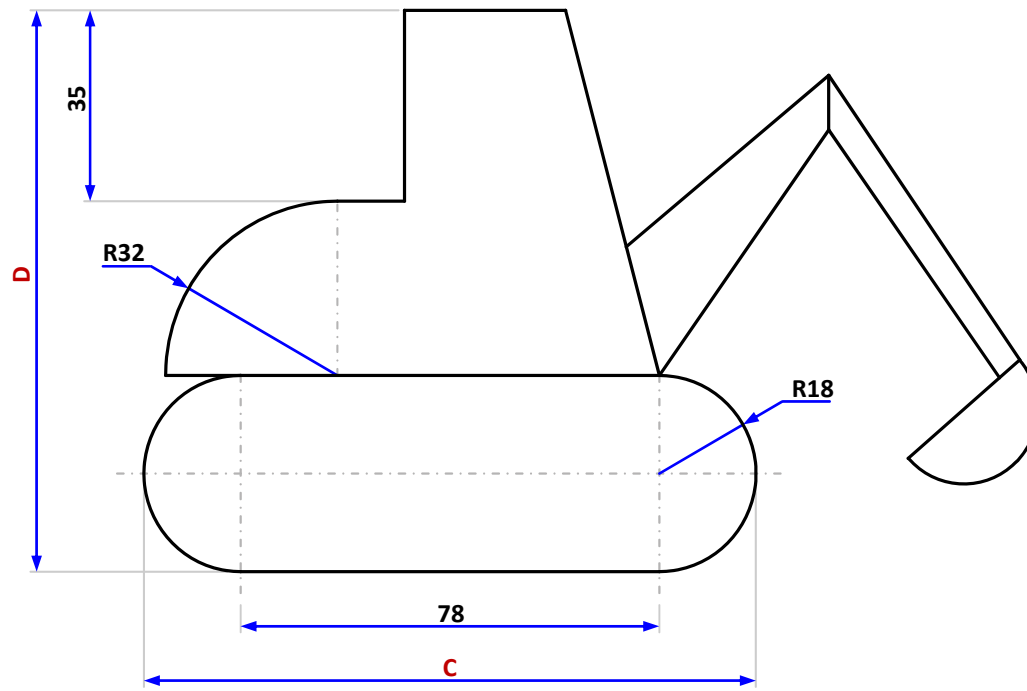
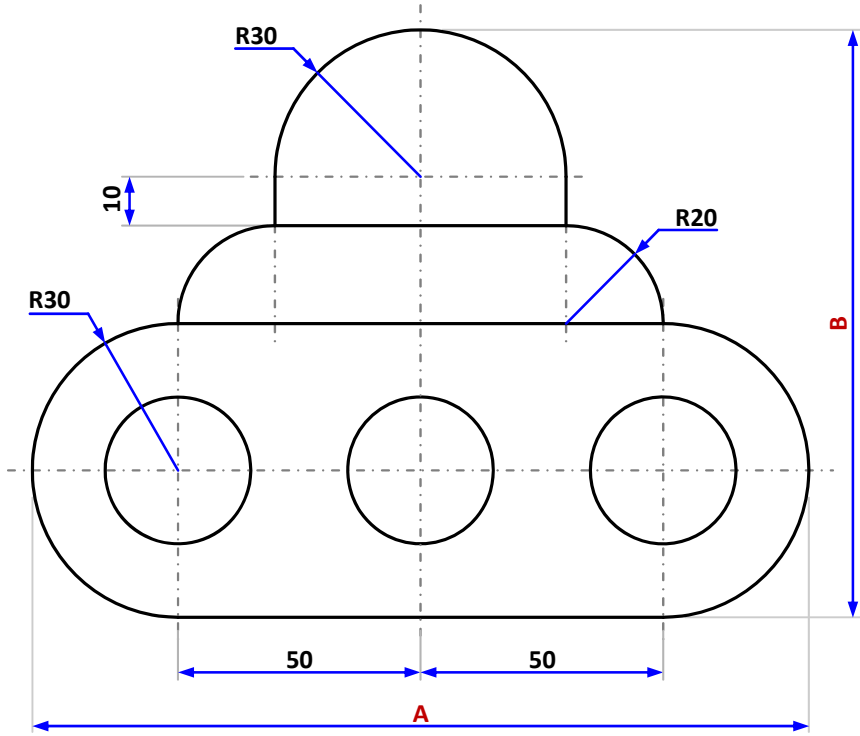

1.9) Measure and write the dimensions of each of the following drawings.

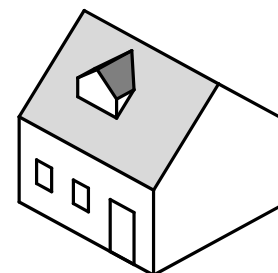
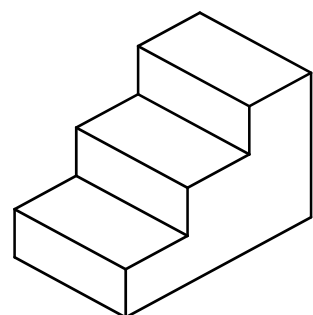
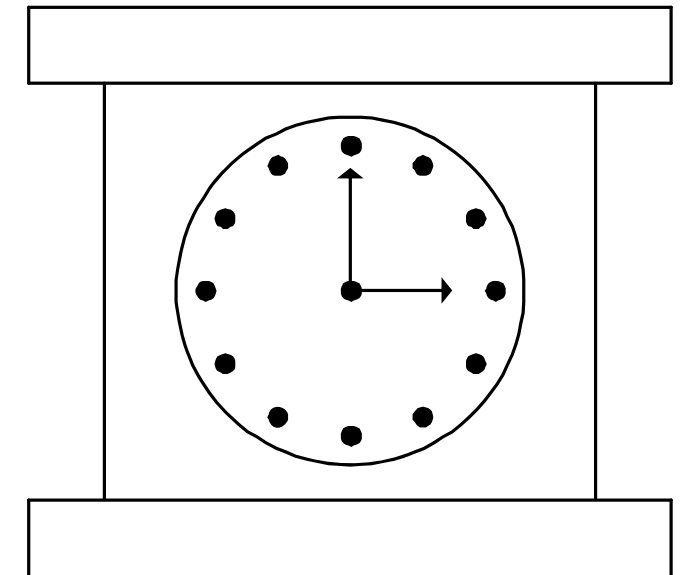
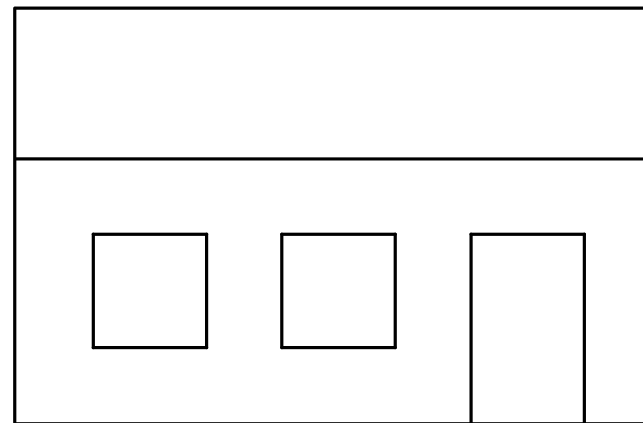
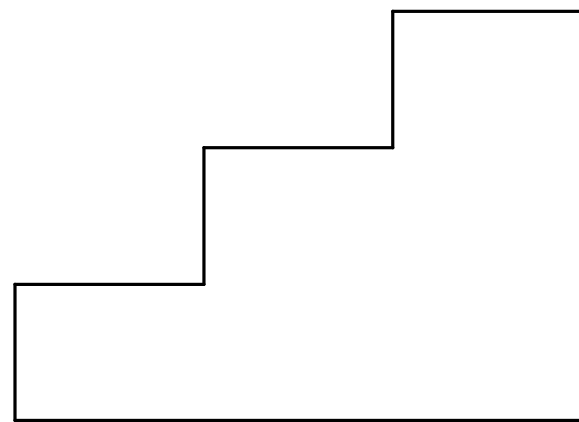

Graphic Solutions		
Name		Introduction to Graphics Sheet 4 Dimensioning
Date		

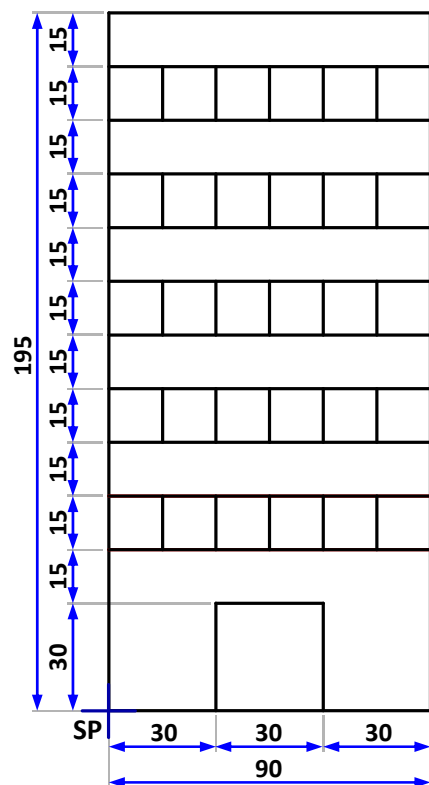

1.10) A drawing of a high-rise building is given.  
 - In the space above reproduce the drawing using the given dimensions.  
 Use the point **SP** at the starting position for the drawing.

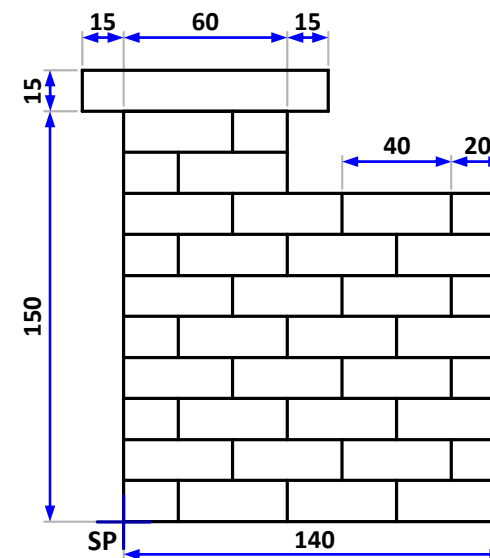
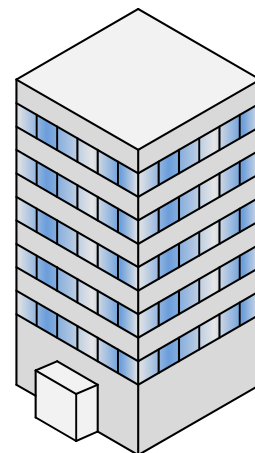

1.11) The graphic to the right shows a pillar.  
 A drawing of a similar pillar is given on the left.  
 - In the space above reproduce the drawing using the given dimensions.  
 Use the point **SP** at the starting position for the drawing.



**Graphic Solutions**

Name		Introduction to Graphics Sheet 5 Drawing with Equipment
Date		

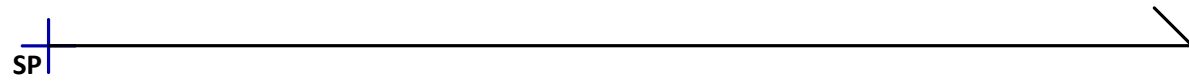

1.12) The drawing supplied shows a logo from a Rail company.  
 - In the space above draw the logo using the given dimensions.  
 Use the point SP at the starting position for the drawing.

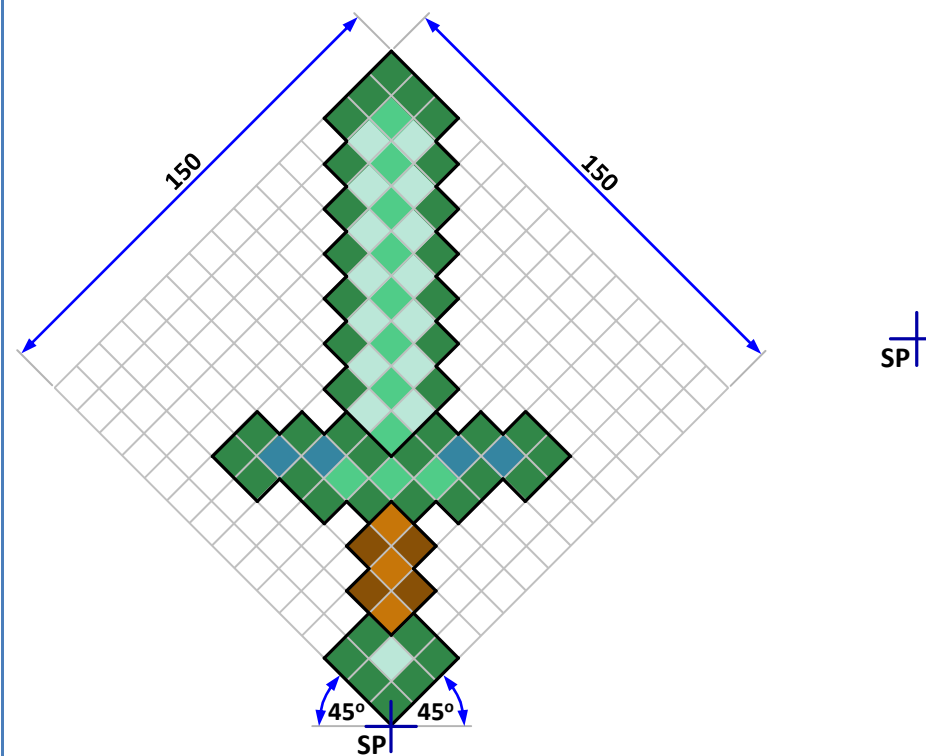
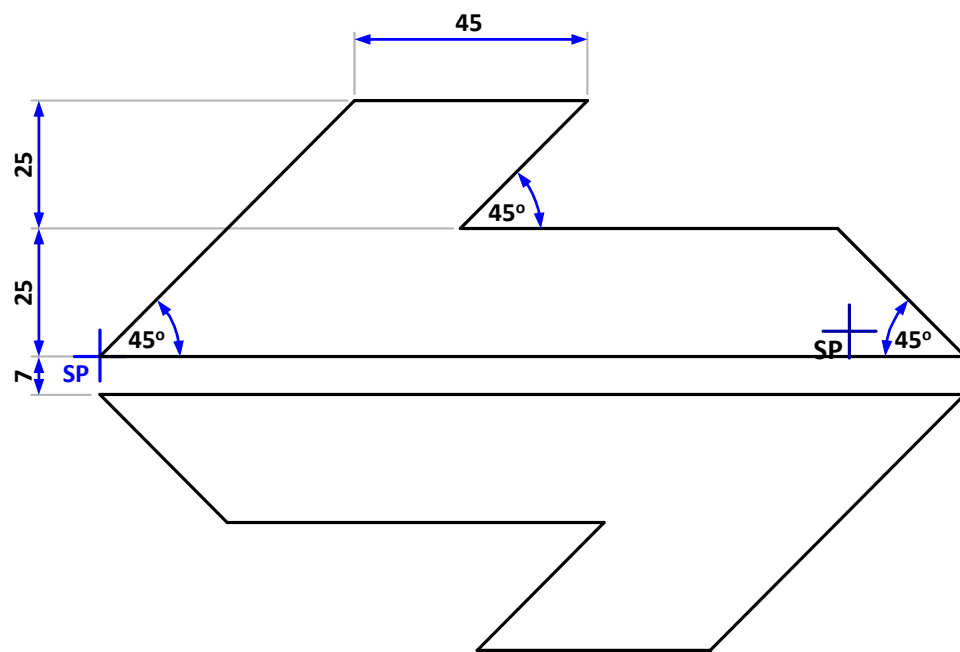

1.13) The drawing shows a mine craft sword in a square grid.

a. The grid lines are spaced at equal distances. What distance is between each grid line?

b. Draw the square grid in light construction lines, then recreate the graphic.

c. Colour or shade the completed drawing.

Graphic Solutions		
Name		Introduction to Graphics Sheet 6 Drawing with Equipment
Date		

# Sample Graphic Solutions

1.14) Circles are usually measured using the radius or the diameter.

a. Label the graphic with **R** for radius and **D** for diameter.

b. Explain the following terms:

**Diameter-**

**Radius-**

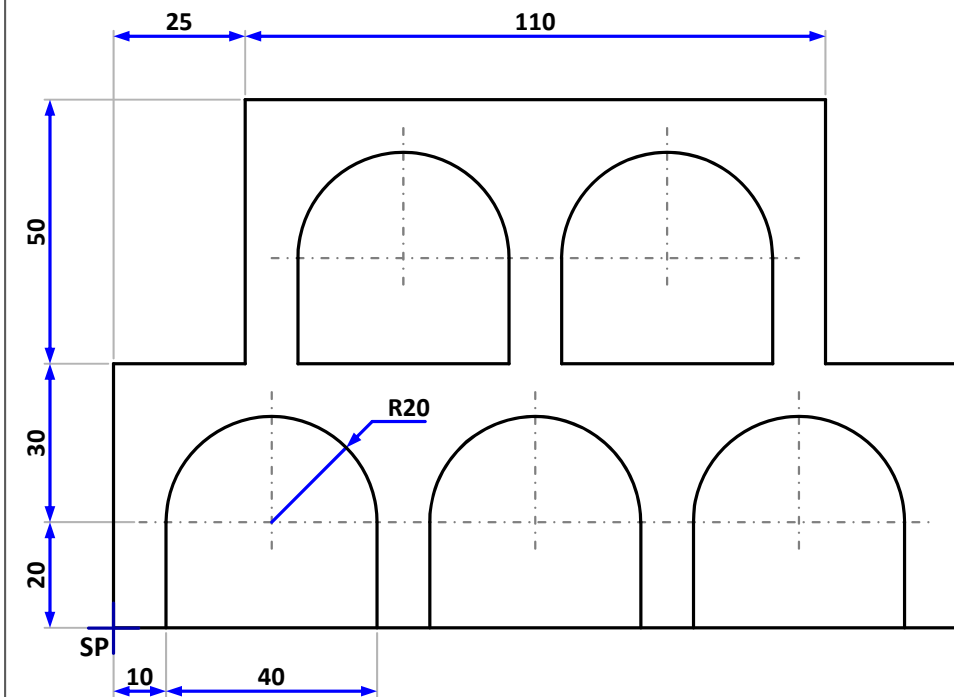
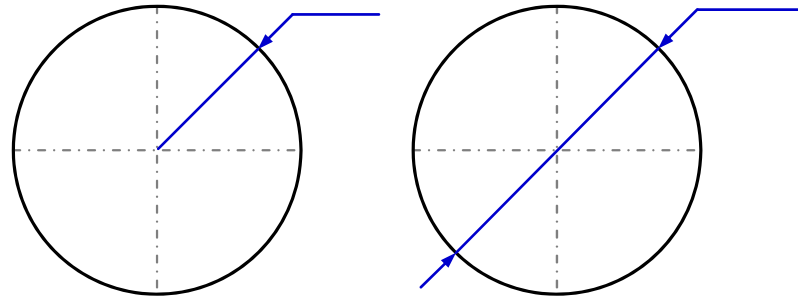

1.15) The drawing supplied shows a view of stone archways.

a. What is the total height of the drawing?

b. What is the total length of the drawing?

c. In the space above draw the stone archway. Balance the drawing so it is centred in the drawing area.

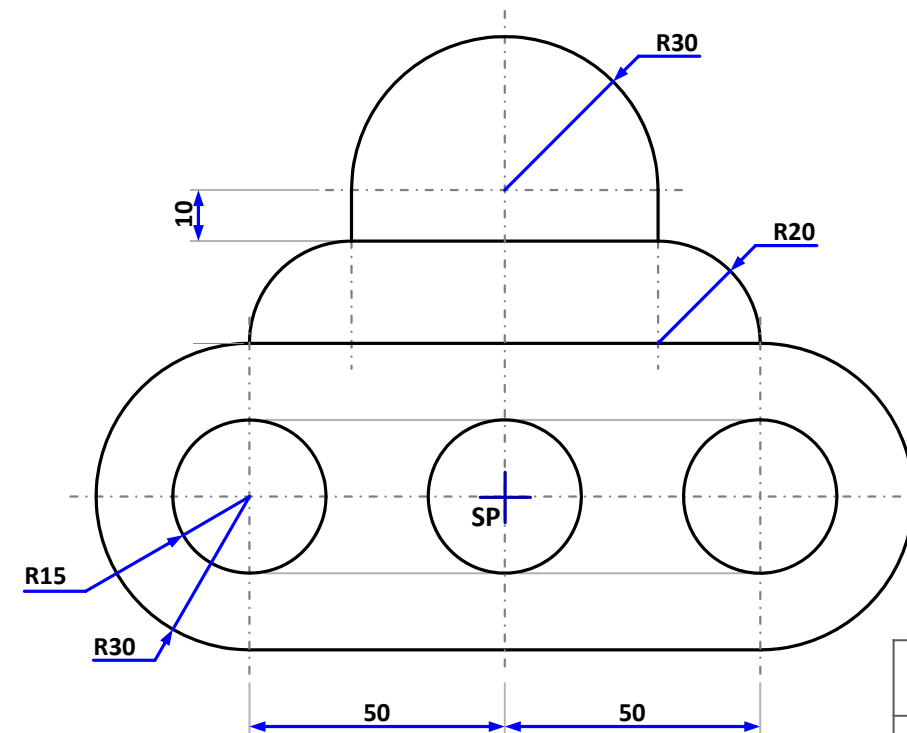

1.16) The drawing supplied shows a UFO.

a. What is the total height of the drawing?

b. What is the total length of the drawing?

c. Draw the UFO, balance the drawing so it is centred in the drawing area.

## Graphic Solutions

Name		Introduction to Graphics Sheet 7 Drawing with Equipment
Date		

SP

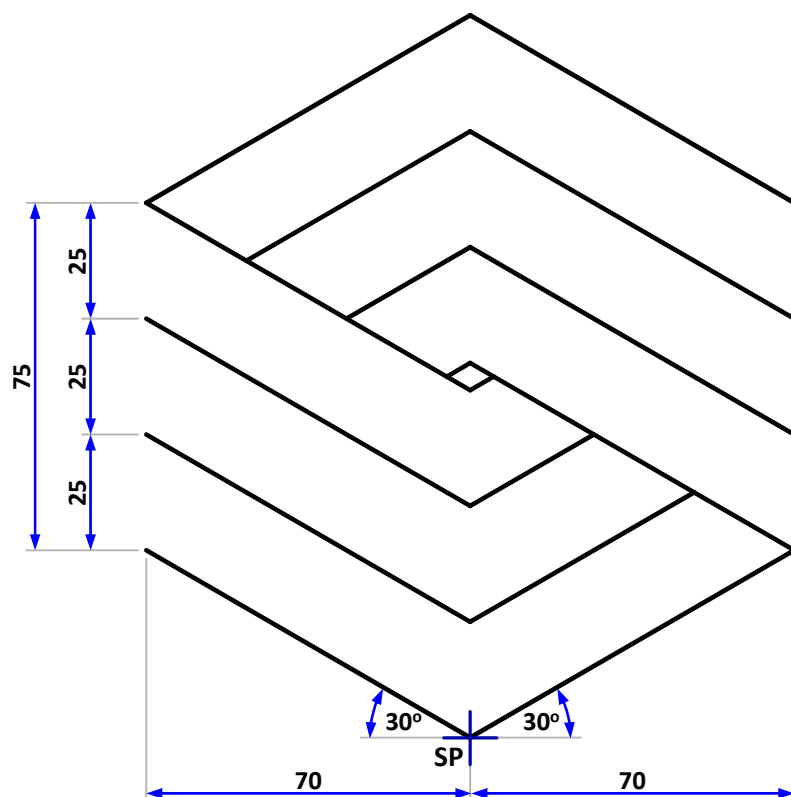

1.17) A logo based on the letter S is given. Recreate the logo using the given dimensions. Use SP at the starting point.

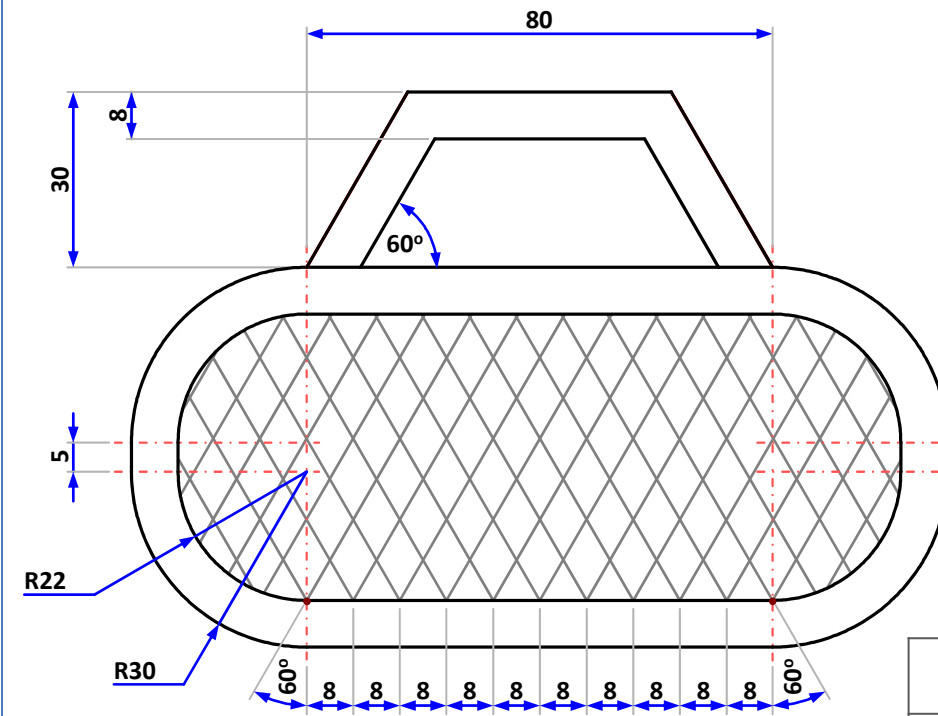

1.18) The drawing supplied shows a portable speaker.

- What is the total height of the drawing?
- What is the total length of the drawing?
- In the space above draw the speaker. Balance the drawing so it is centred in the drawing area.

Graphic Solutions		
Name		Introduction to Graphics Sheet 8 Drawing with Equipment
Date		

# Sample Graphic Solutions

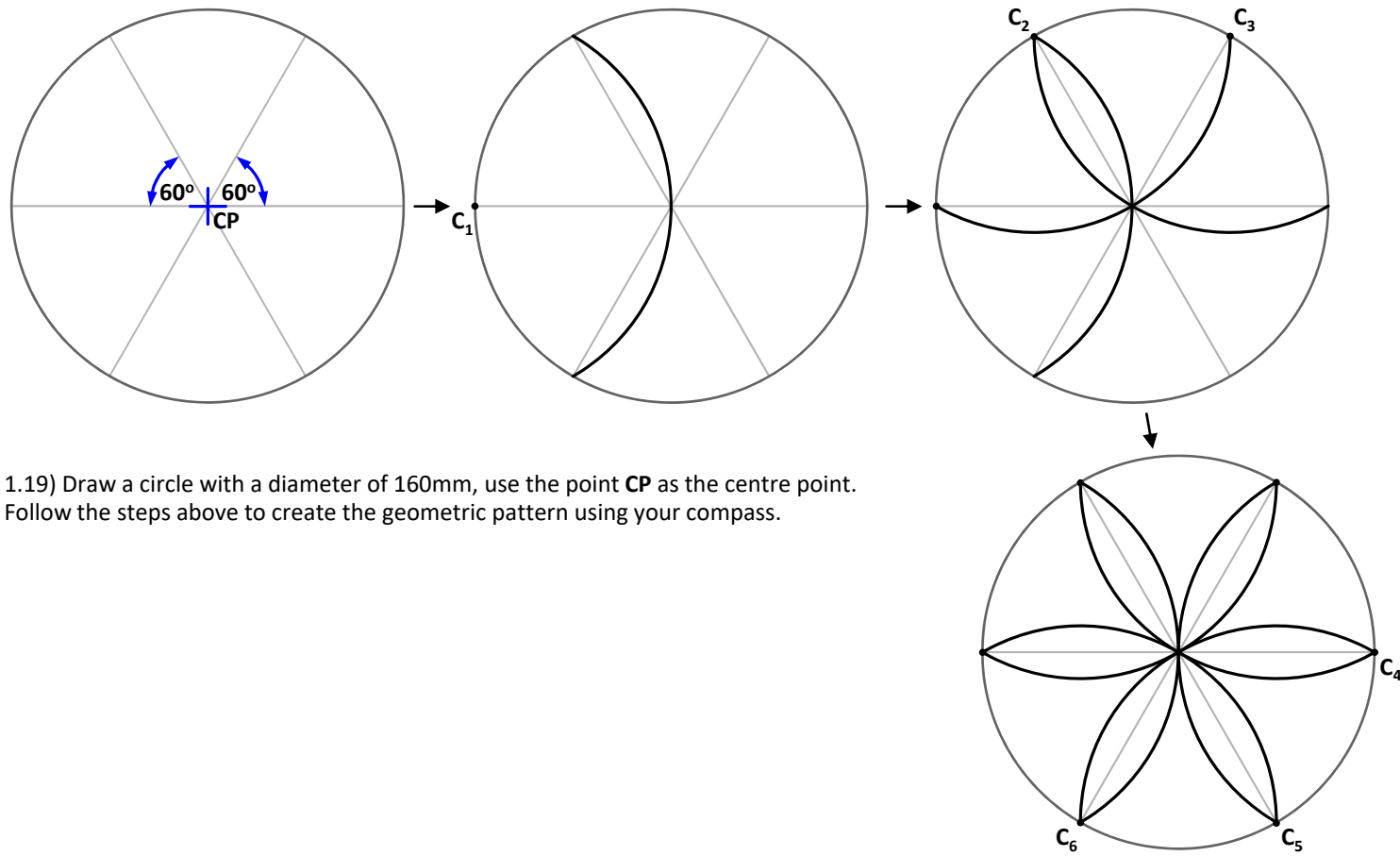

1.19) Draw a circle with a diameter of 160mm, use the point **CP** as the centre point. Follow the steps above to create the geometric pattern using your compass.

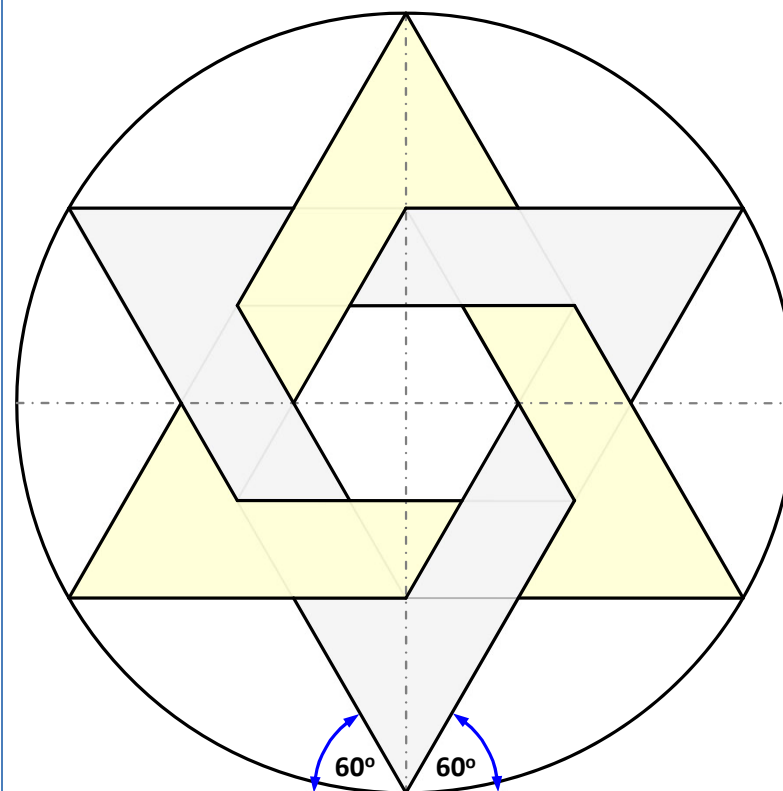
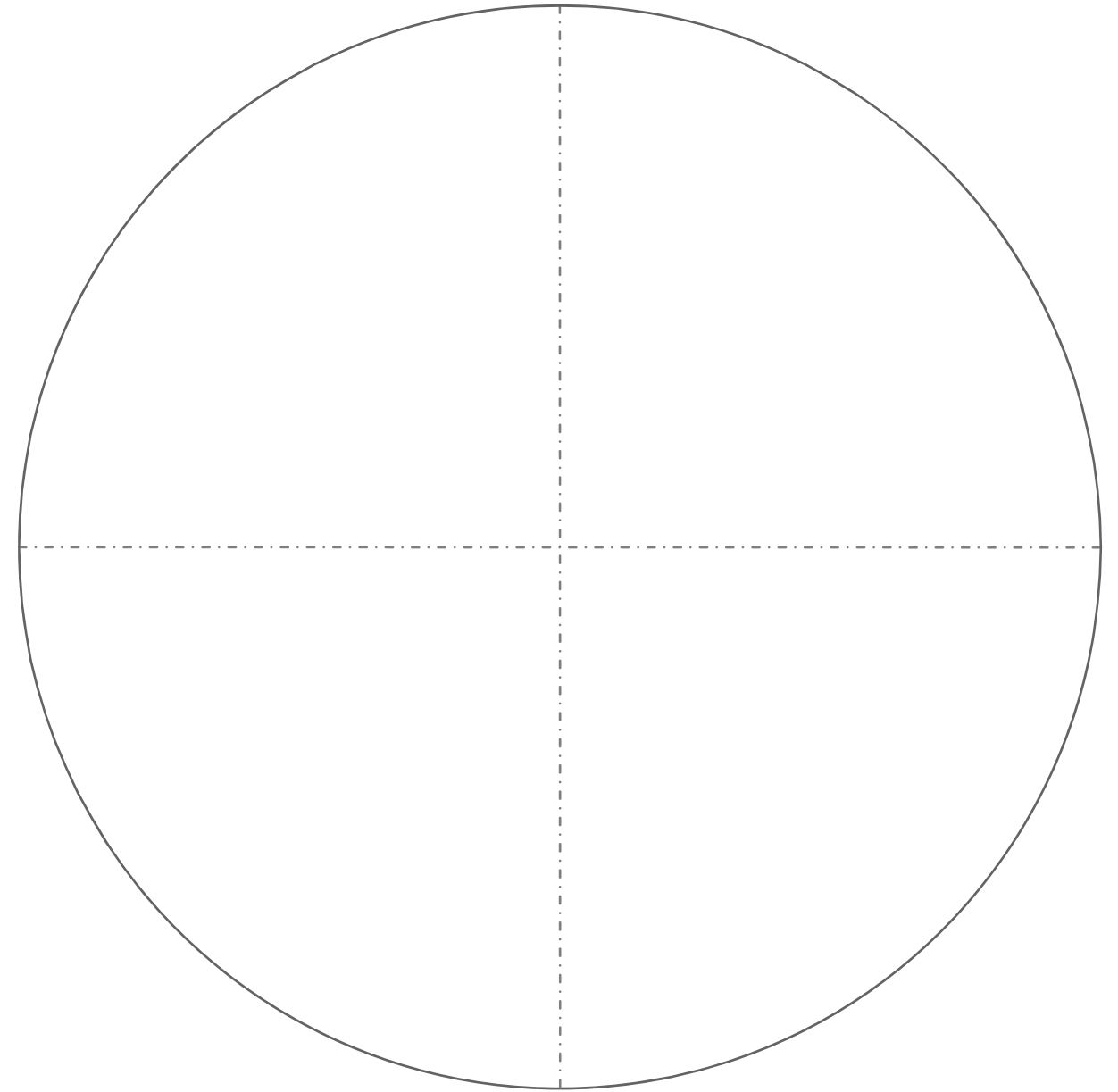

1.20) Use your 30°/60° set square to reproduce the given drawing in the circle above. Note: Use light construction lines to first draw the overlapping triangles.

Graphic Solutions		
Name		Introduction to Graphics Sheet 9 Drawing with Equipment
Date		

# Sample Graphic Solutions

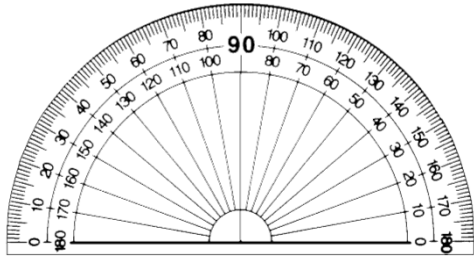

1.21) Identify the drawing equipment shown in the diagram and explain what it is used for.  
Equipment-

Use-

What is vertex of an angle?

1.23) Use your protractor to complete the given angle.

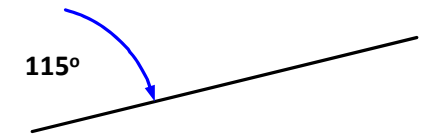
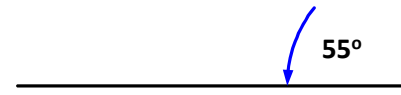

1.22) Measure and label each of the given angles.

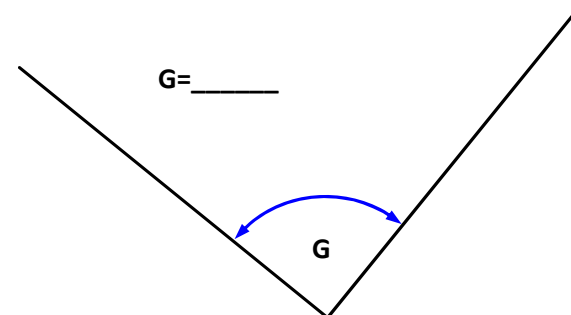
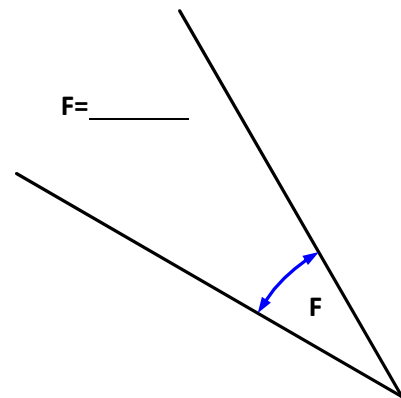
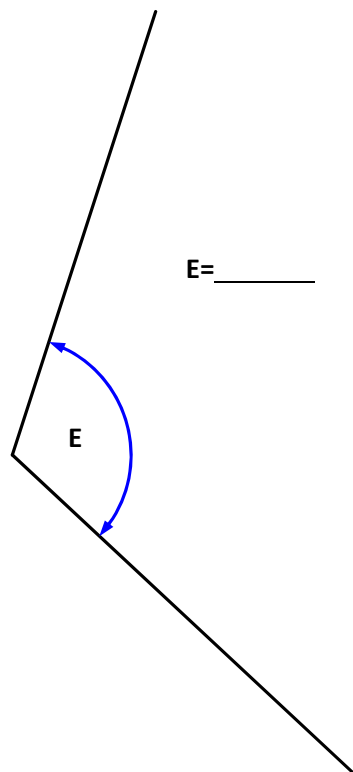
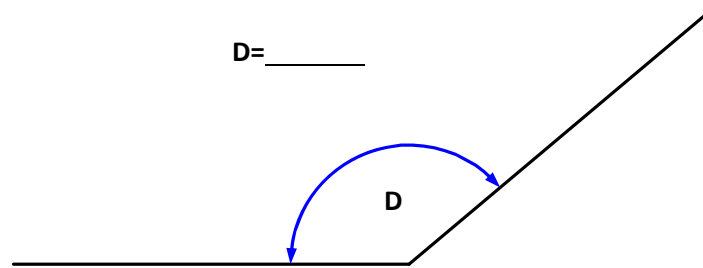
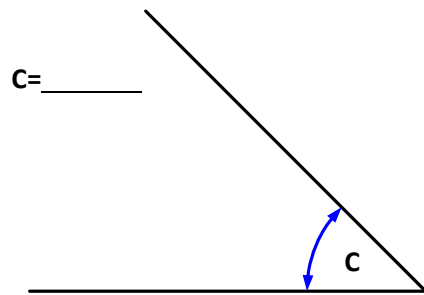
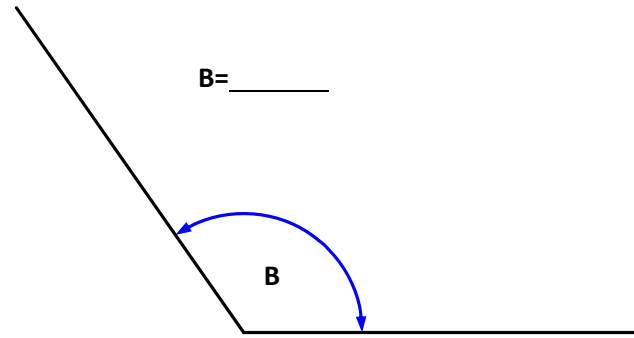
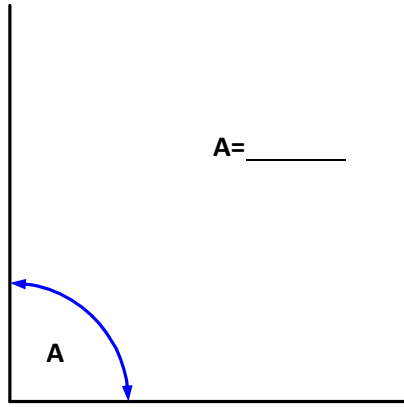

SP

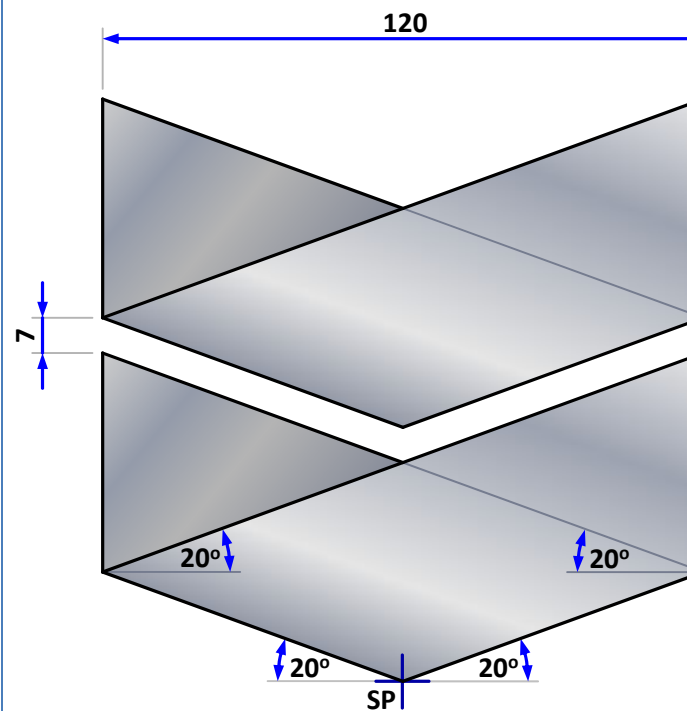

1.24) Redraw the given logo using the point SP, given above, as the starting point for the drawing.

Graphic Solutions		
Name		Introduction to Graphics Sheet 10 Protractor & Inclined Lines
Date		



# Sample Graphic Solutions

SP

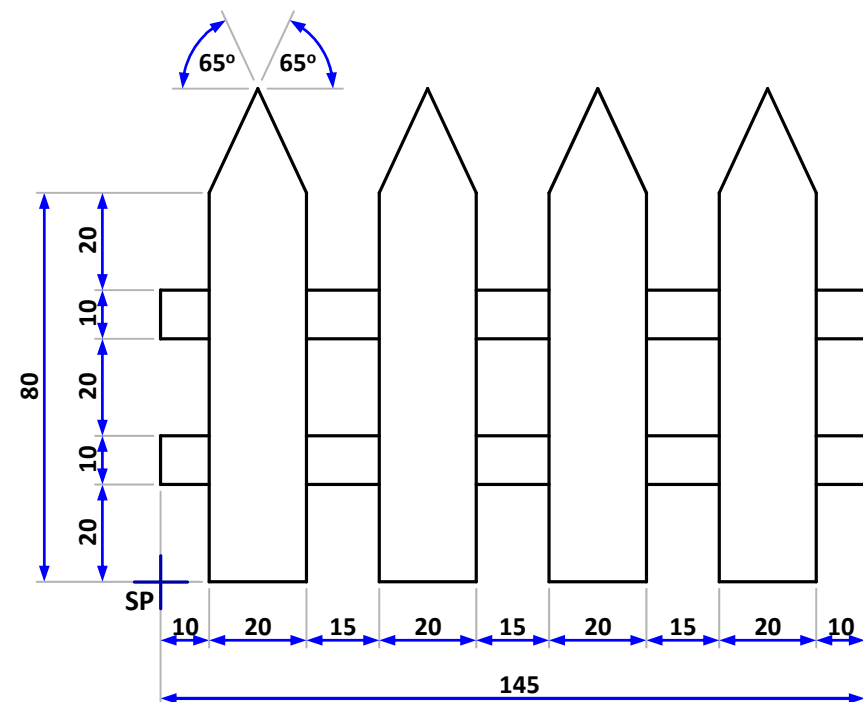

1.25) The drawing shows a portion of a fence. Draw the fence using the given dimensions. Use **SP** at the starting point.

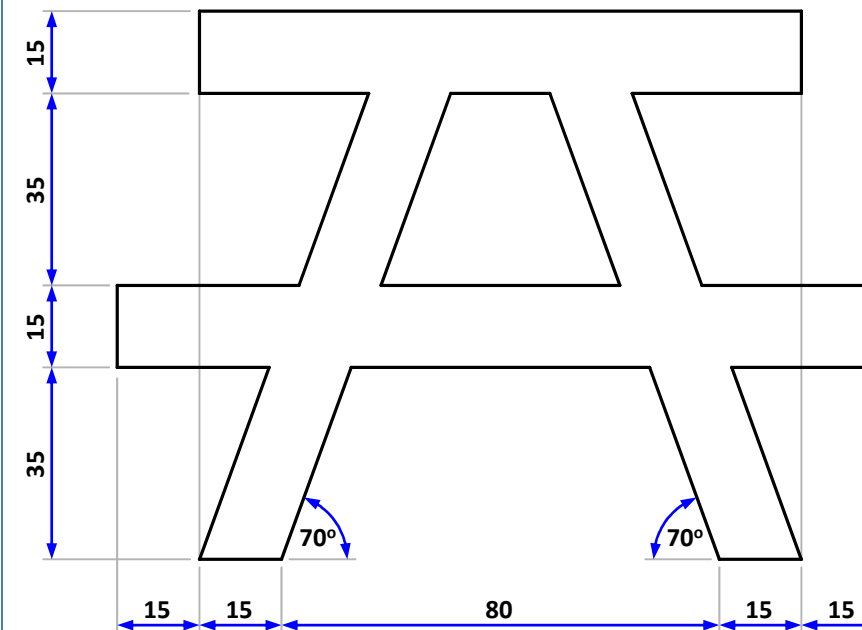

1.26) The symbol for a picnic area is show.  
 a. What is the total height of the drawing?  
 \_\_\_\_\_  
 b. What is the total length of the drawing?  
 \_\_\_\_\_  
 c. Draw the symbol, balance the drawing so it is centred in the drawing area.

Graphic Solutions		
Name		Introduction to Graphics Sheet 11 Protractor & Inclined Lines
Date		

# Sample Graphic Solutions

1.27) Draw a circle with a diameter of 120mm, using the point **CP** as the centre point.  
Construct a five pointed star within the circle.  
Hint: A full circle is 360°, 5 points are needed for the star

Calculations Area

CP

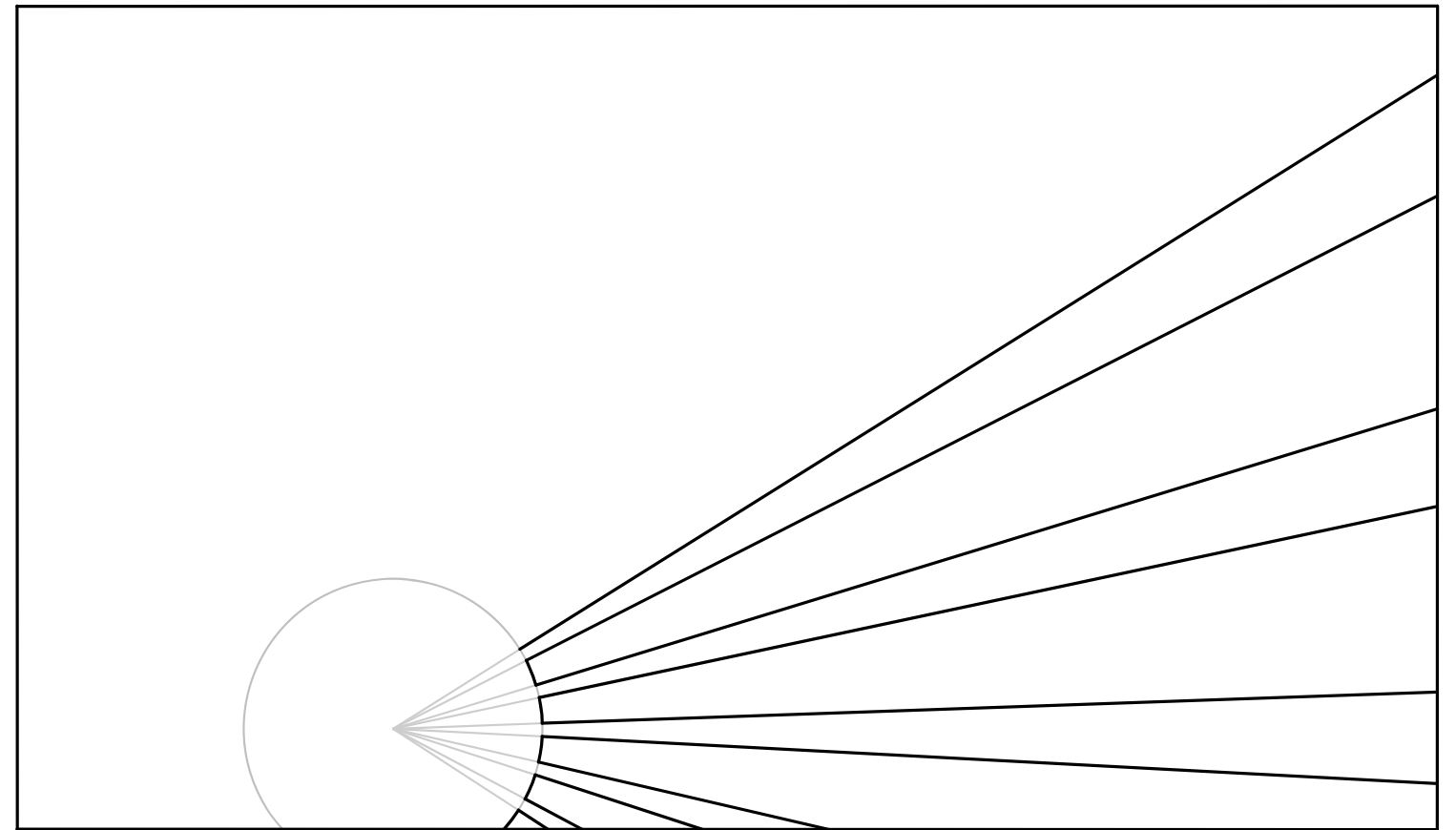
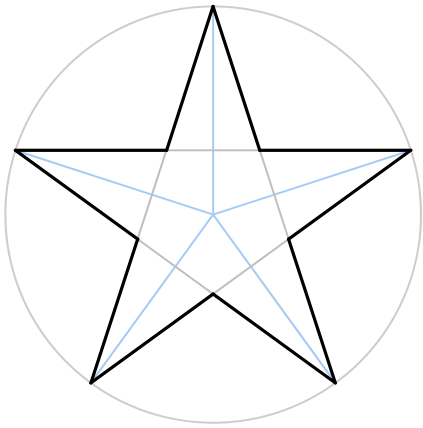

1.28) The graphic above shows a partial flag based on sun rays. Measure the angles between the rays given and repeat the pattern in order to complete the drawing.

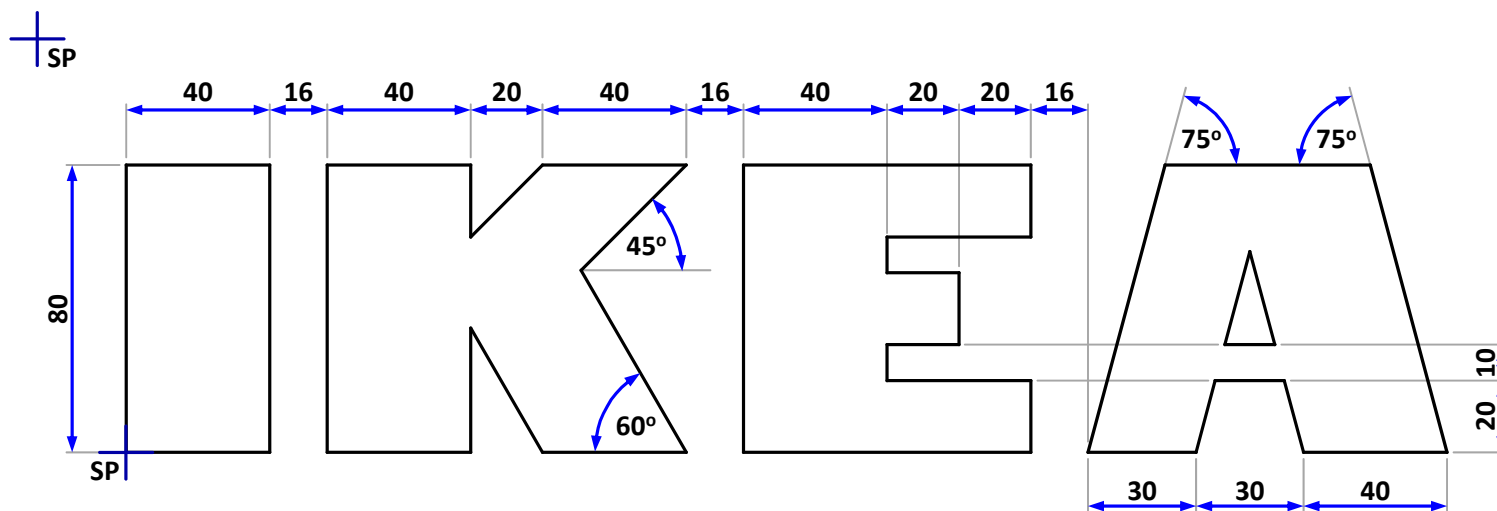

1.29) Using **SP** as the starting point draw the **IKEA** monogram using the measurements provided.

What is a Monogram?

Graphic Solutions		
Name		Introduction to Graphics Sheet 12 Protractor & Inclined Lines
Date		

